

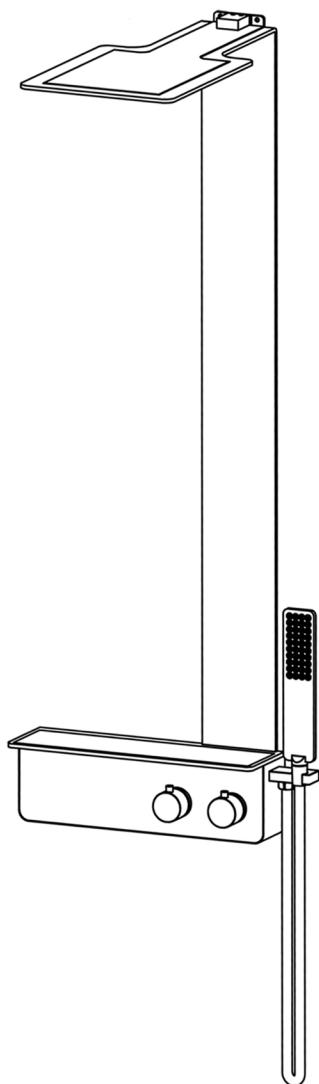

VANITADOCCE
SHOWERS

VITA DX

PANNELLO DOCCIA



600.900.300R



VANITADOCCE

SHOWERS

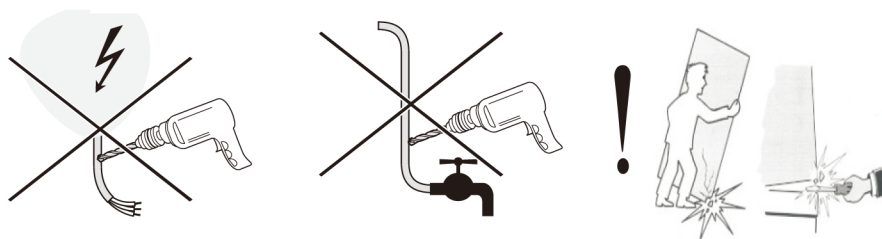

(GB) Please check that all products are present and undamaged before commencing installation. We will not be held responsible for visible defects after the product is installed. Do not use thinners. After unpacking, always protect it (for example with cardboard) when placing on the floor. Installation instructions for skilled craftsmen. Following installation, hand the 1nsta1lat1on instructions over to the end customer.

(IT) Prima del montaggio è necessario verificare che i prodotti siano integri e privi di danni. Dopo l'installazione, il produttore non si assume più la responsabilità di eventuali vizi apparenti. Non utilizzare diluenti! Quando si toglie dalla confezione, appoggiarlo sempre sul pavimento proteggendolo con cartone. Istruzioni di montaggio per l'installatore specializzato. Le istruzioni di montaggio devono essere consegnate al cliente finale al termine del montaggio.

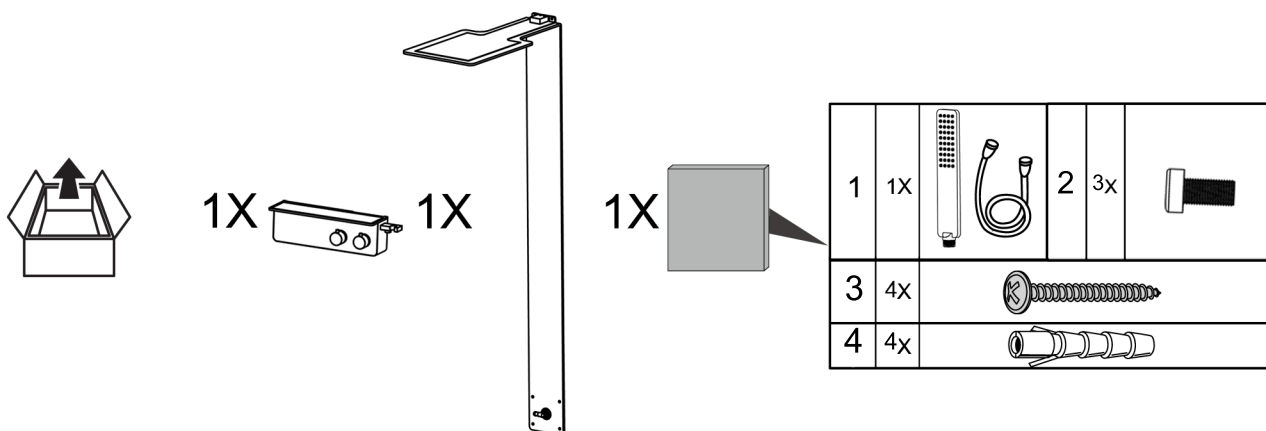
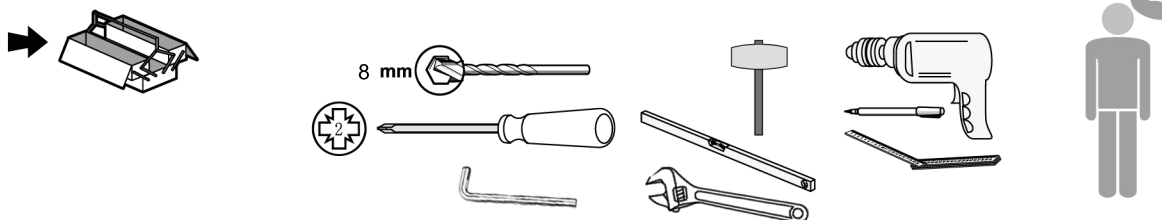



VANITADOCCE

SHOWERS

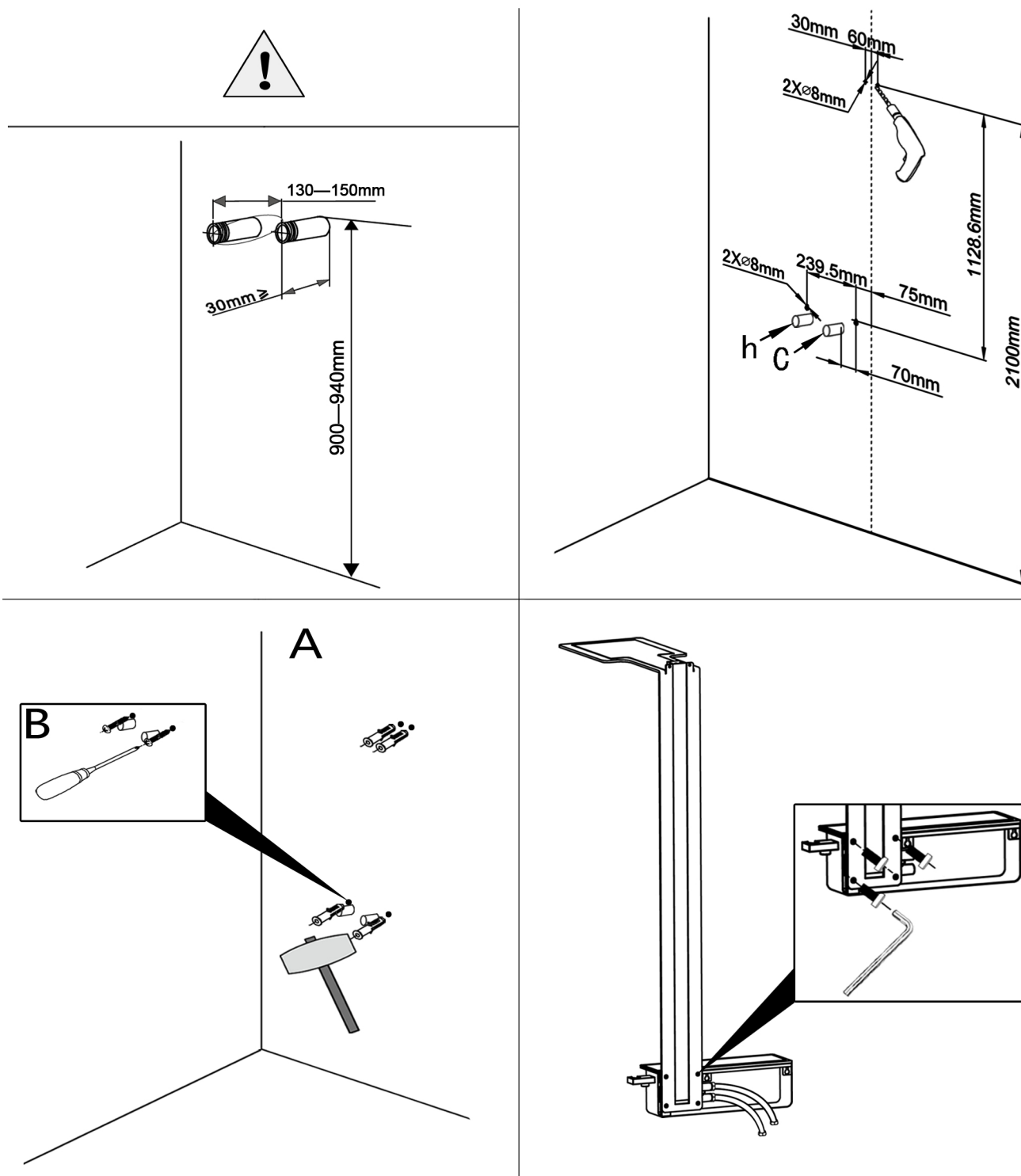



VANITADOCCE

SHOWERS

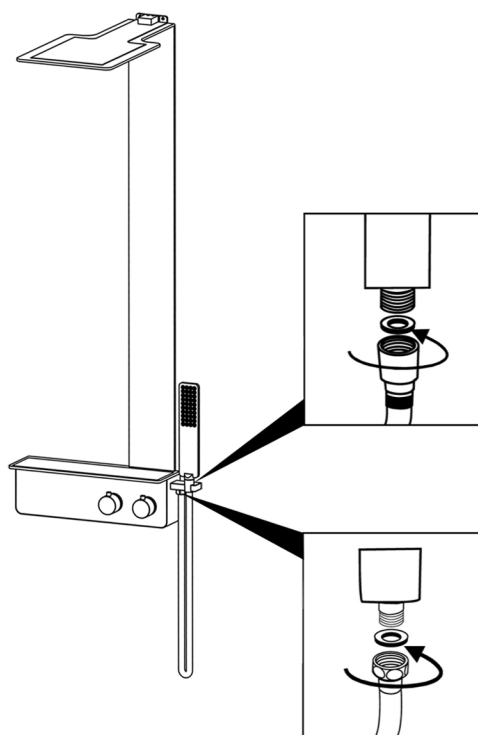
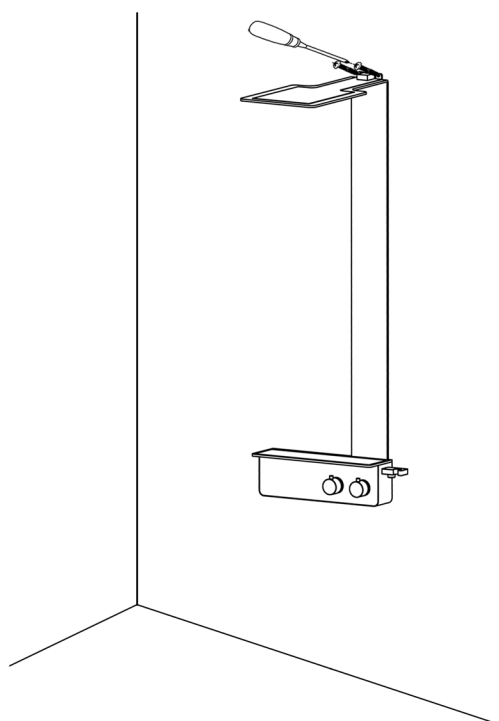
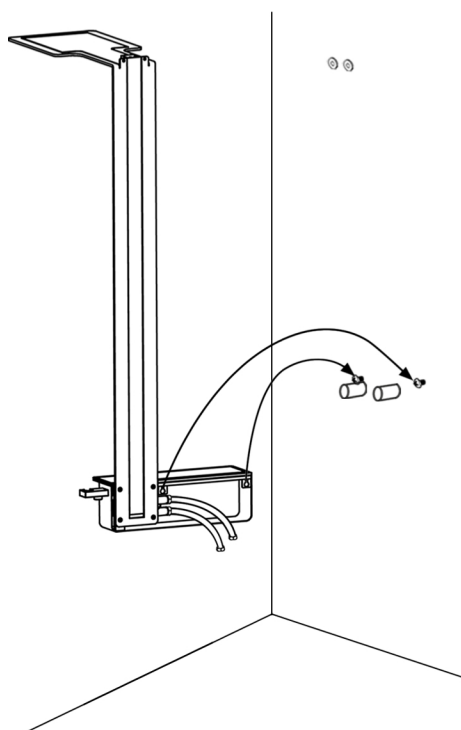
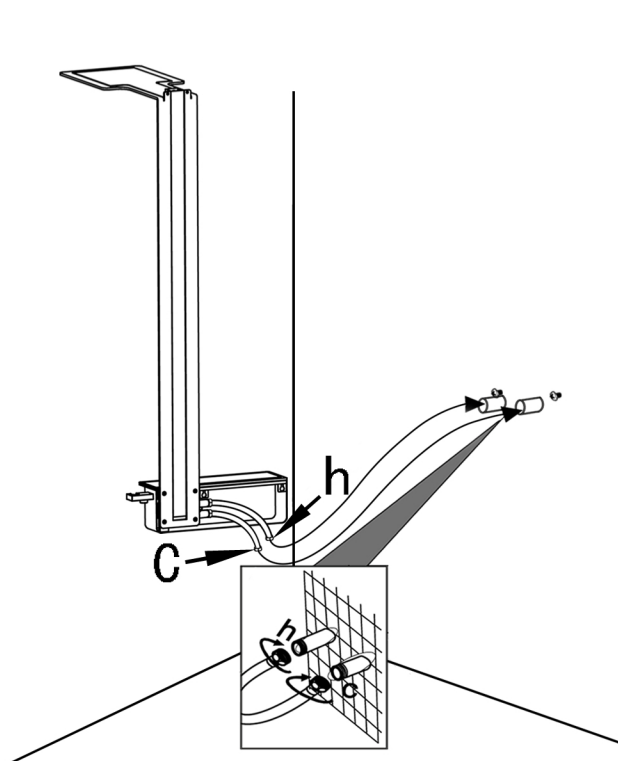



VANITADOCCE
SHOWERS

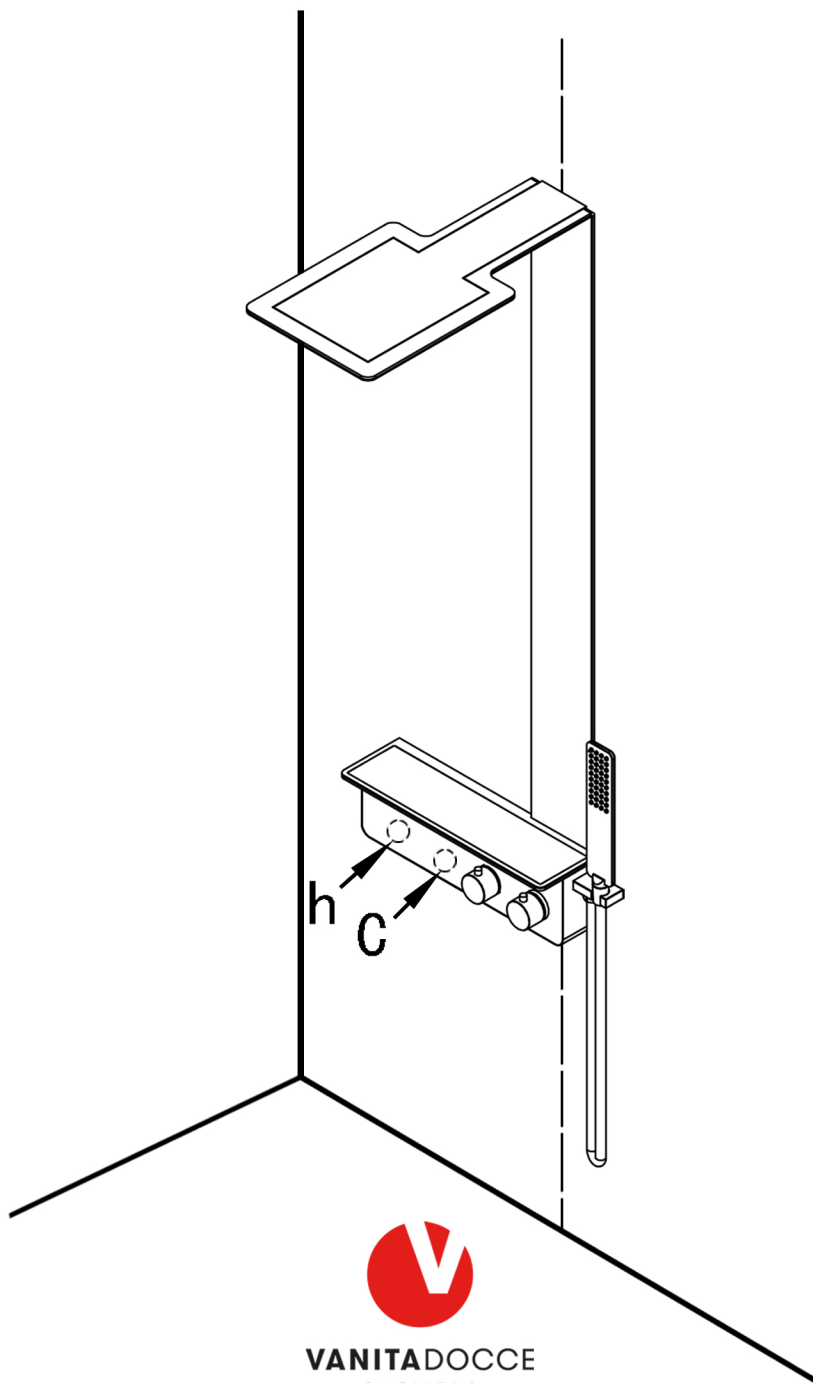

VANITADOCCE
SHOWERS

WWW.VANITADOCCE.COM

PROGETTATO E IMPORTATO
DA VANITA DOCCE SRL